

# DEFEND HANDGUARD KIT



P/N 2884616-XXX

## APPLICATION

Verify accessory fitment at [www.polaris.com](http://www.polaris.com).

## BEFORE YOU BEGIN

Read these instructions and check to be sure all parts and tools are accounted for. Please retain these installation instructions for future reference and parts ordering information.

## REQUIRED SOLD SEPARATELY

Only parts for installation of the Defend Handguard Kit are included. For complete installation, the following additional kit is required (sold separately):

- *Defend Handguard Mounts*, P/N 2884617

## KIT CONTENTS

### DEFEND HANDGUARDS - P/N 2884616-XXX

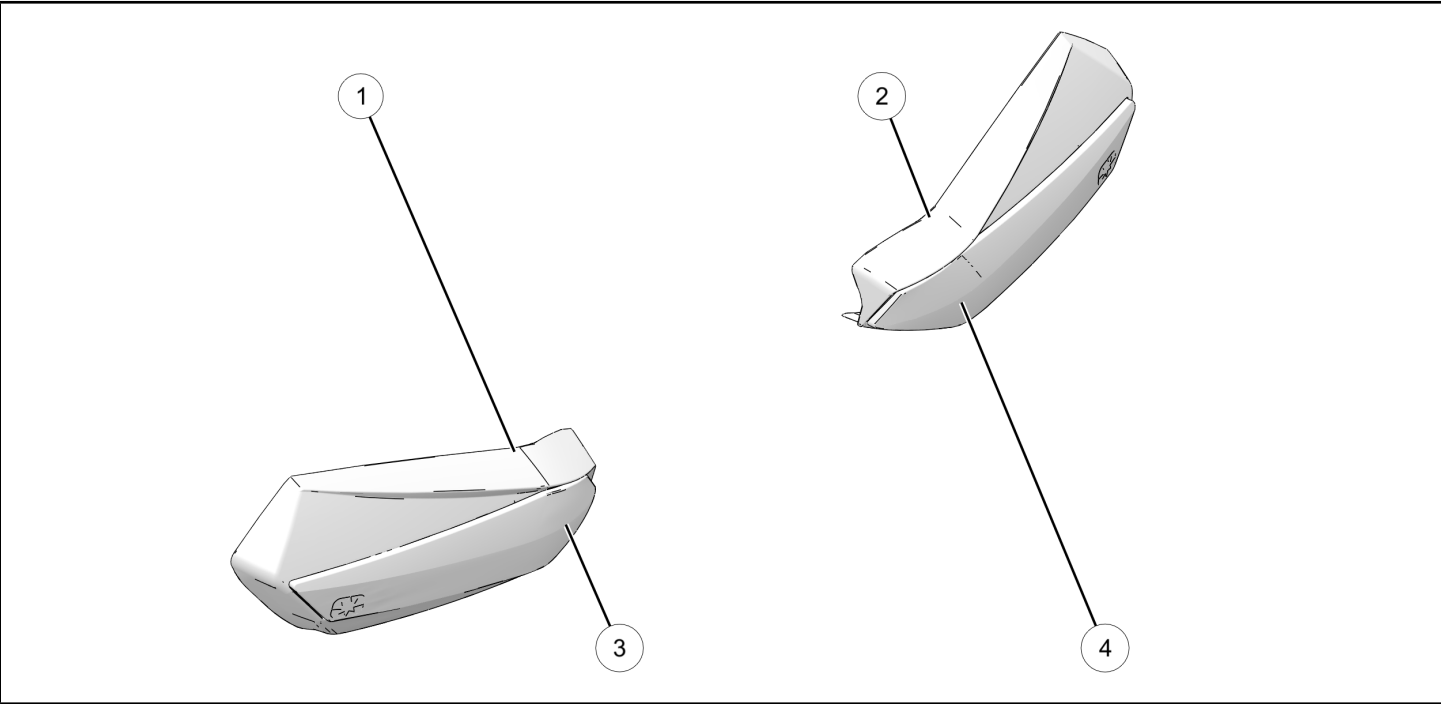

NOTICE	
XXX = Polaris® color code (For example: 266 = Black)	

REF	QTY	PART DESCRIPTION	P/N AVAILABLE SEPARATELY
1	1	RH Handguard	N/A
2	1	LH Handguard	N/A
3	1	LH Handguard Cap	N/A
4	1	RH Handguard Cap	N/A

## DEFEND HANDGUARD MOUNTS - P/N 2884617 (SOLD SEPARATELY)

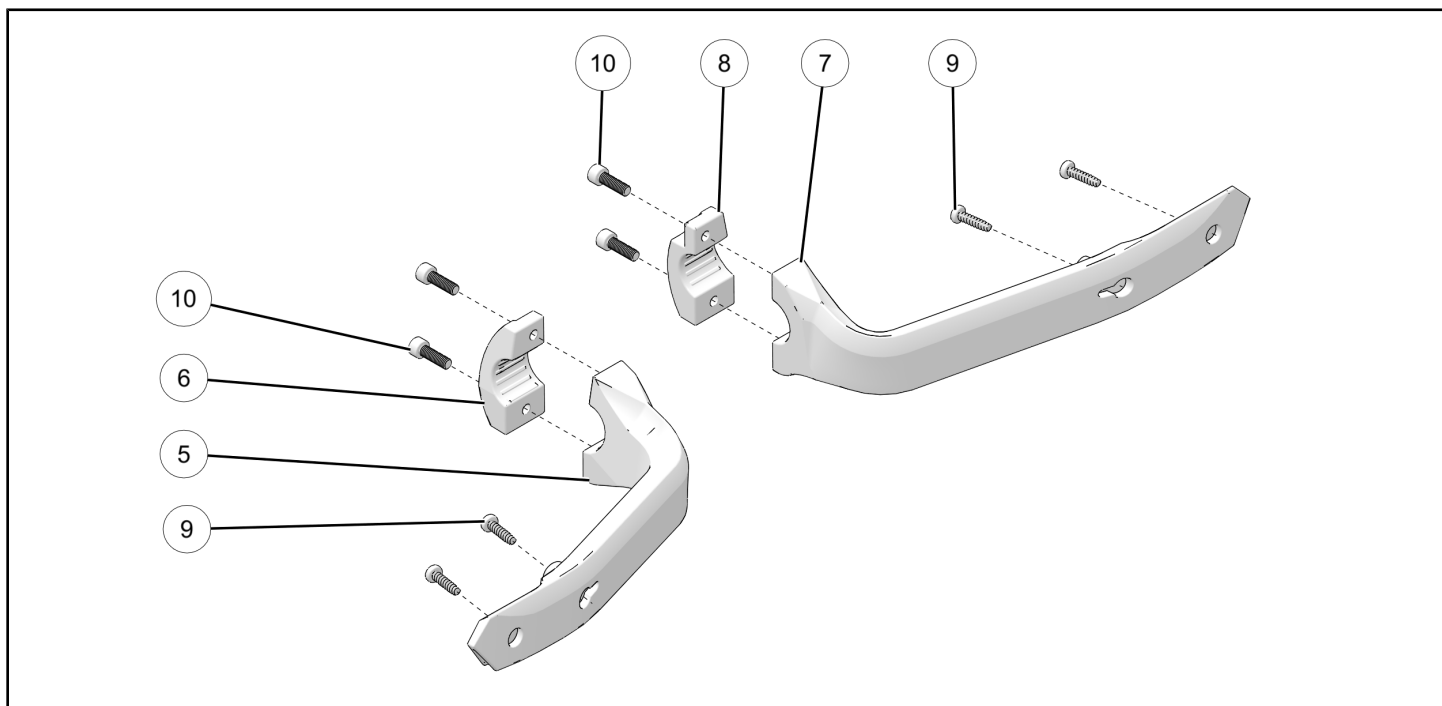

REF	QTY	PART DESCRIPTION	P/N AVAILABLE SEPARATELY
5	1	RH Mounting Arm	N/A
6	1	RH Mounting Clamp	N/A
7	1	LH Mounting Arm	N/A
8	1	LH Mounting Clamp	N/A
9	4	Screw, Plastic Tapping, M4 0.55 X 16	N/A
10	4	Screw, Socket Head Cap, M5 0.8 X 16	N/A

### TOOLS REQUIRED

- Safety Glasses
- Socket Set, Torx® Bit
- Socket Set, Hex Bit, Metric
- Torque Wrench

### IMPORTANT

Your Defend Handguard Kit is exclusively designed for your vehicle. Please read the installation instructions thoroughly before beginning. Installation is easier if the vehicle is clean and free of debris. For your safety, and to ensure a satisfactory installation, perform all installation steps correctly in the sequence shown.

# INSTALLATION INSTRUCTIONS

## VEHICLE PREPARATION

### GENERAL

1. Park snowmobile on a flat surface.
2. Push the engine stop switch down to the OFF position.
3. Turn the key to the OFF position and remove key.

## ACCESSORY INSTALLATION

### HANDGUARD / MOUNT ASSEMBLY

1. Install RH handguard ① onto RH mounting arm ⑤ using two of the provided screws ⑨. DO NOT overtighten.

#### TORQUE

Handguard Fasteners:  
**Tighten Until Fully Seated**

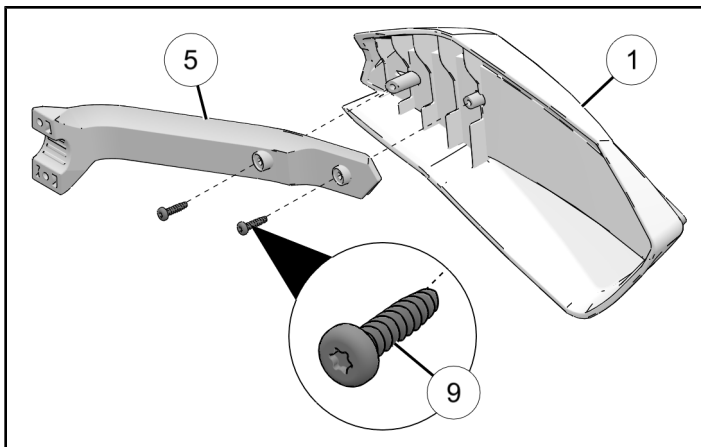

2. Repeat step 1 for opposite side.

### HANDGUARD INSTALLATION

1. Place LH handguard assembly into position as shown. Loosely install the LH mounting cap ⑧ using supplied fasteners ⑩.

#### IMPORTANT

Be sure that you DO NOT pinch any electrical wires or brake line between the mounts themselves and/or handlebars when installing.

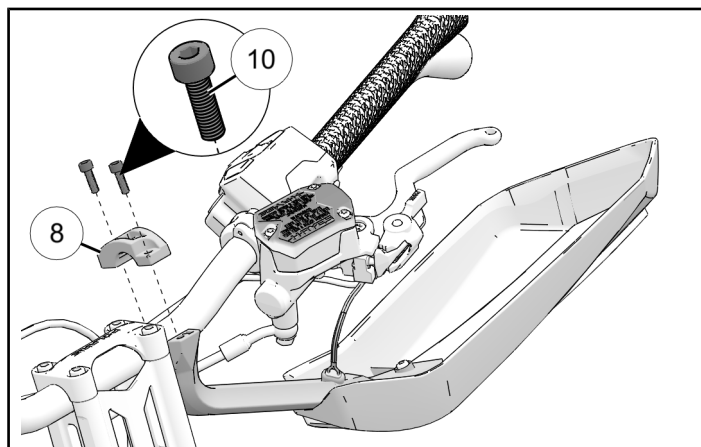

2. Carefully rotate the handguard assembly upward and into position.

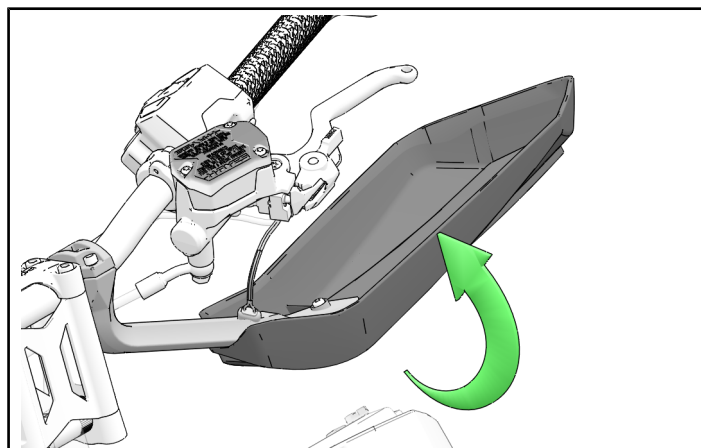

3. Verify that the handguard assembly does not interfere with the brake mechanism. Make sure that the parking brake locking mechanism is free to rotate into the fully locked position and does not make contact with the upper mount or any other portion of the handguard assembly.

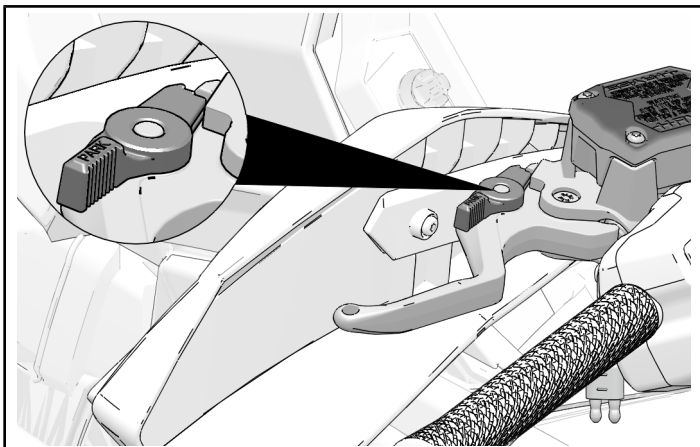

**⚠ WARNING**

You **MUST VERIFY** brake mechanism has full brake and parking brake functions after installation of handguards and **BEFORE** starting engine. Adjust handguards if necessary to avoid any interference with brake function.

Failure to comply could result in death or serious personal injury.

4. Once in the proper position, torque mounting fasteners ⑩ to specification.

**NOTICE**

Make sure the handguard mount is right up against the handlebar riser.

Tighten the top mounting fastener first to reduce the gap between the mount and rear clamp.

**TORQUE**

Handguard Mounting Fasteners:  
**18 in-lbs (2 N·m)**

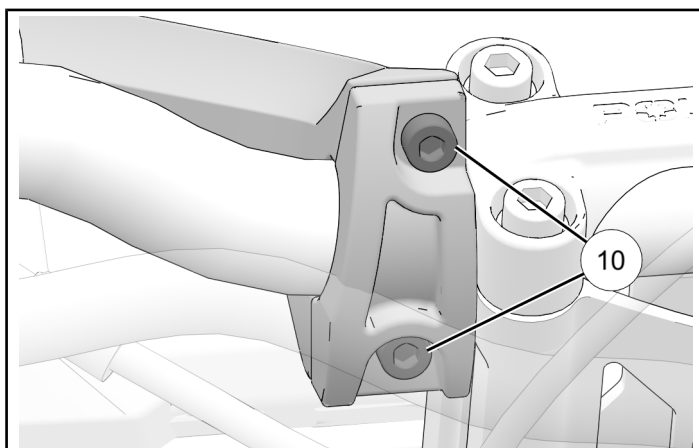

5. Place RH handguard assembly into position as shown. Loosely install the RH mounting cap ⑥ using supplied fasteners ⑩.

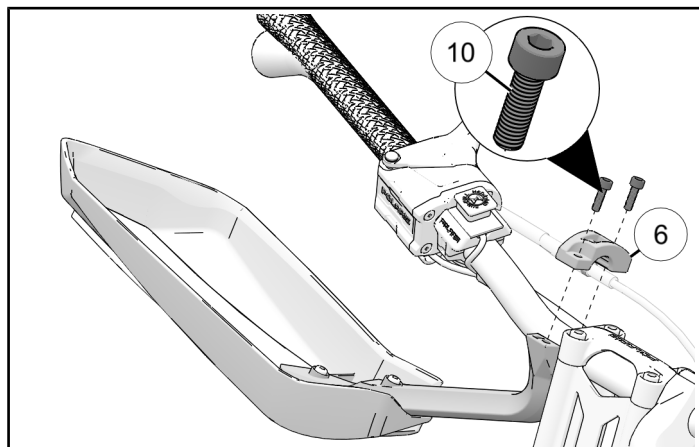

6. Carefully rotate the handguard assembly upward and into position.

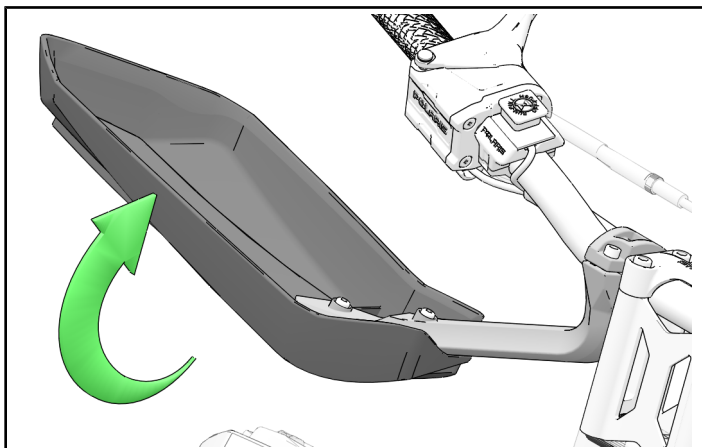

7. Once again, be sure to verify there are no pinched electrical wires and/or cables.

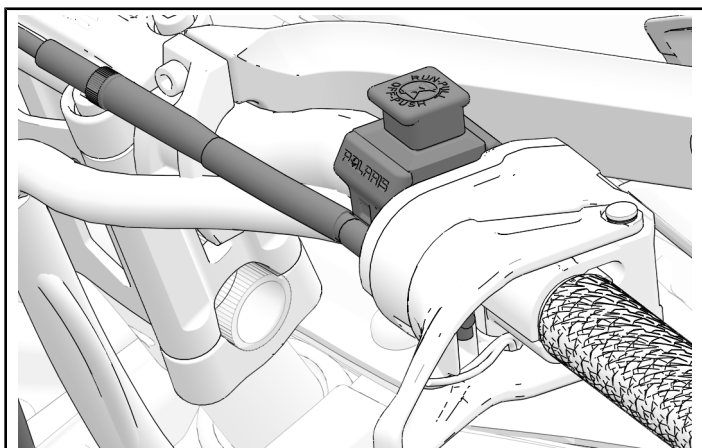

8. Once in the proper position, torque mounting fasteners ⑩ to specification.

#### NOTICE

Make sure the handguard mount is right up against the handlebar riser.

Tighten the top mounting fastener first to reduce the gap between the mount and rear clamp.

#### TORQUE

Handguard Mounting Fasteners:  
**18 in-lbs (2 N·m)**

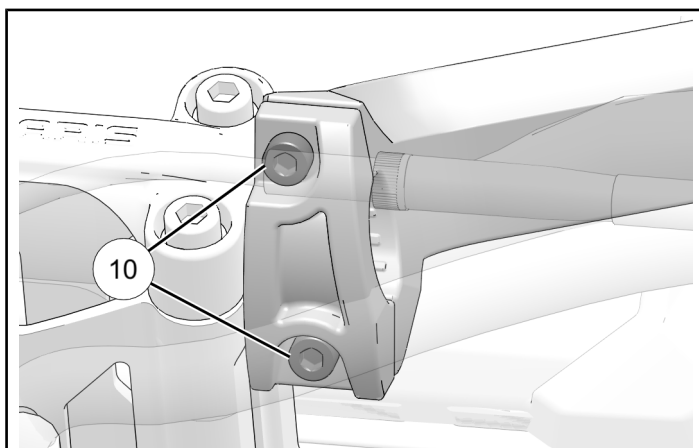

#### ⚠ WARNING

You **MUST VERIFY** throttle mechanism has the recommended amount of free-play listed in the service manual for your specific model after installation of handguards and **BEFORE** starting engine. Adjust handguard if necessary to avoid any interference with throttle function.

Failure to comply could result in death or serious personal injury.

## INSTRUCTION FEEDBACK FORM

A feedback form has been created for the installer to provide any comments, questions or concerns about the installation instructions. The form is viewable on mobile devices by scanning the QR code or by clicking [HERE](#) if viewing on a PC.

