

SENTRY SKID PLATE KIT



P/N 2884816

APPLICATION

Verify accessory fitment at www.polaris.com

BEFORE YOU BEGIN

Read these instructions and check to be sure all parts and tools are accounted for. Please retain these installation instructions for future reference and parts ordering information.

KIT CONTENTS

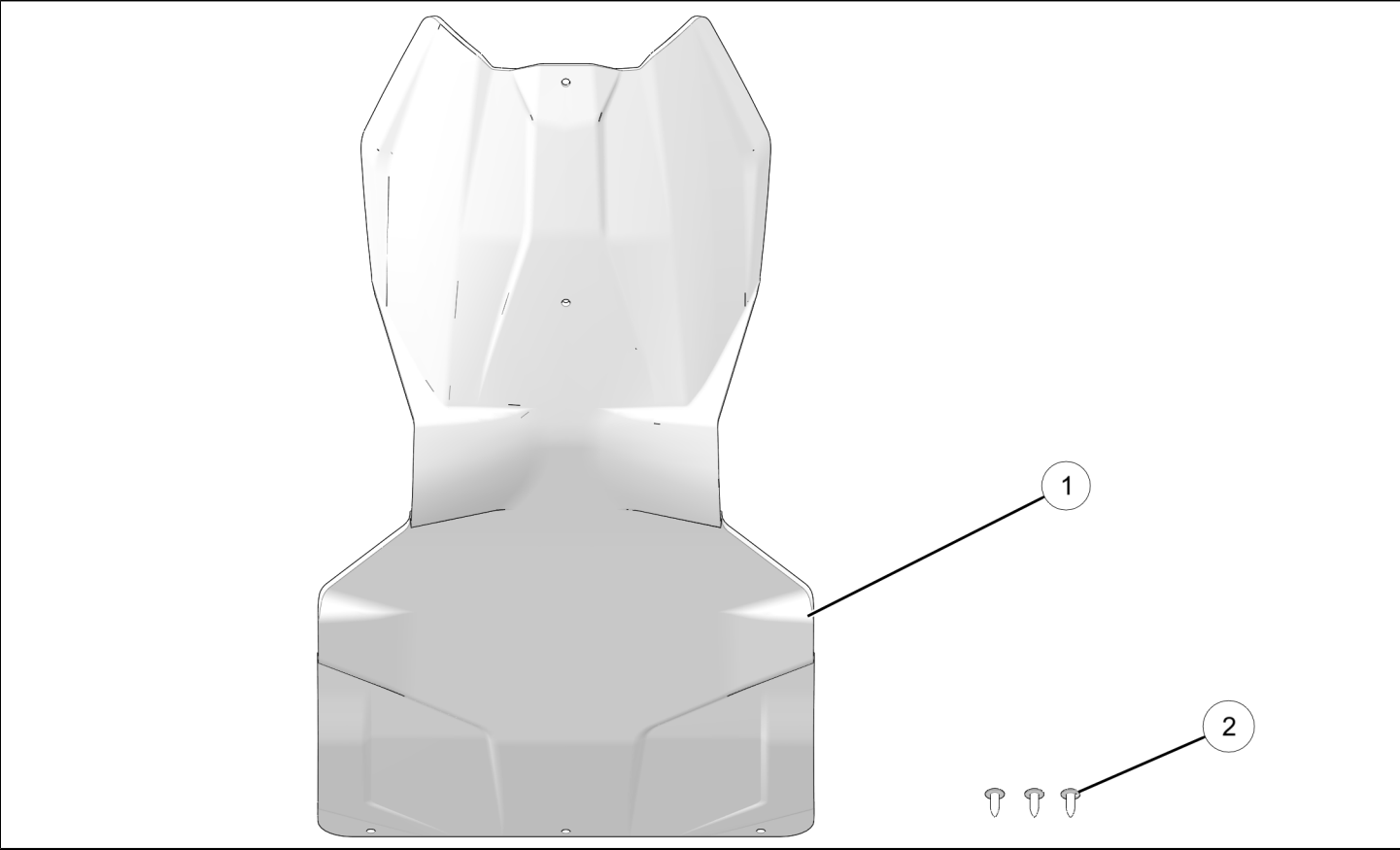

NOTICE

XXX = Polaris® color code (For example: 070 = Black)

REF	QTY	PART DESCRIPTION	PART NUMBER
1	1	Sentry Skid Plate Kit (Includes Item 2)	2884816-XXX
2	3	Screw, Self Drilling #10-16 X 1 TX	7521355

TOOLS REQUIRED

- Safety Glasses
- Deburring Tool
- Socket Set, Metric
- Socket Set, Torx® Bit
- Torque Wrench
- Wrench Set, Metric

CONSUMABLES REQUIRED

- None

IMPORTANT

Your Sentry Skid Plate Kit is exclusively designed for your vehicle. Please read the installation instructions thoroughly before beginning. Installation is easier if the vehicle is clean and free of debris. For your safety, and to ensure a satisfactory installation, perform all installation steps correctly in the sequence shown.

INSTALLATION INSTRUCTIONS

VEHICLE PREPARATION

GENERAL

1. Ensure vehicle is on a flat, stable surface.
2. Turn key to “OFF” position and remove from vehicle.
3. Remove hood and side panels.

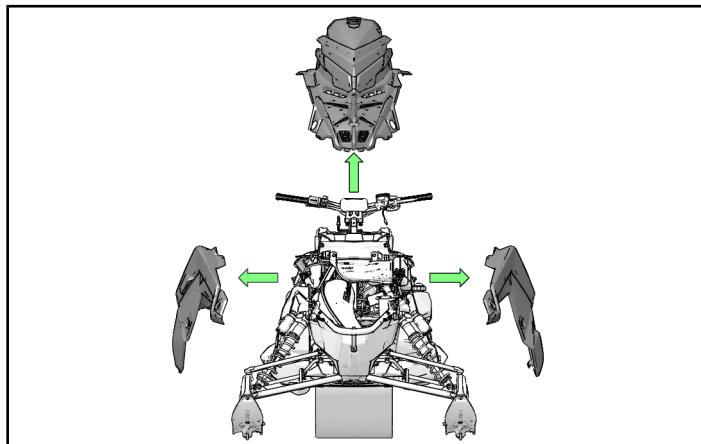

4. Loosen the two rear bumper mounting fasteners but do not remove.

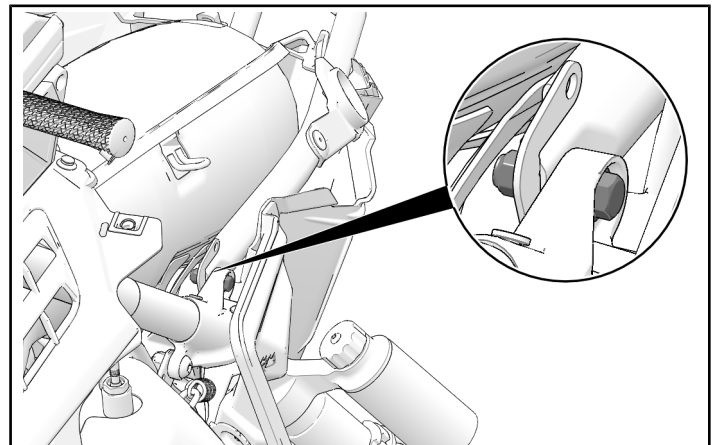
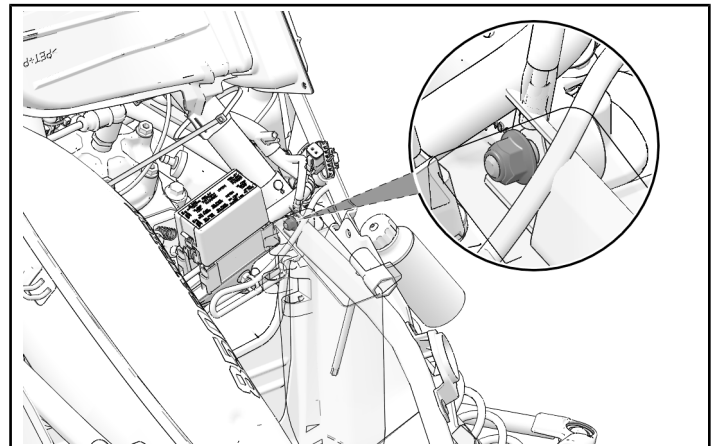

- Remove the two screws holding the left and right hand side of bumper to the nose pan as shown. Keep screws for later use.

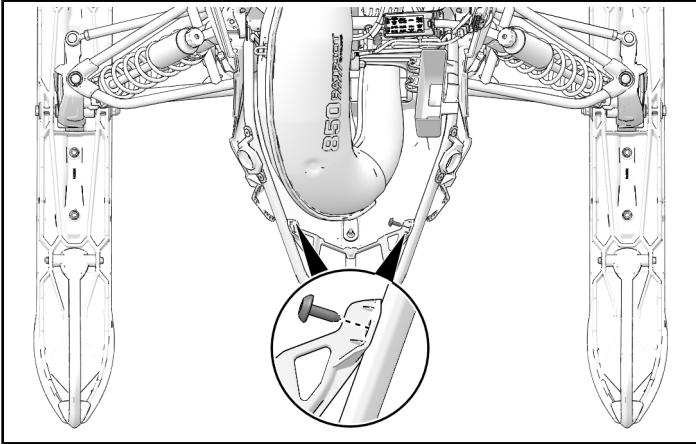

- Remove the upper bumper support bolt and nut. Keep bolt and nut for later use.

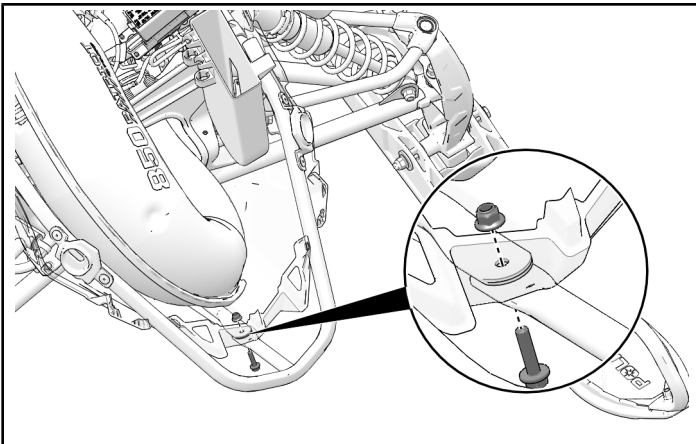

- Slowly rotate vehicle onto its right side.

⚠ WARNING

Use extreme care when rotating vehicle onto the side. Be sure the vehicle is on a suitable surface that is flat and stable before rotating and slowly rotate to avoid over centering the vehicle. Failure to comply could result in severe injury or death.

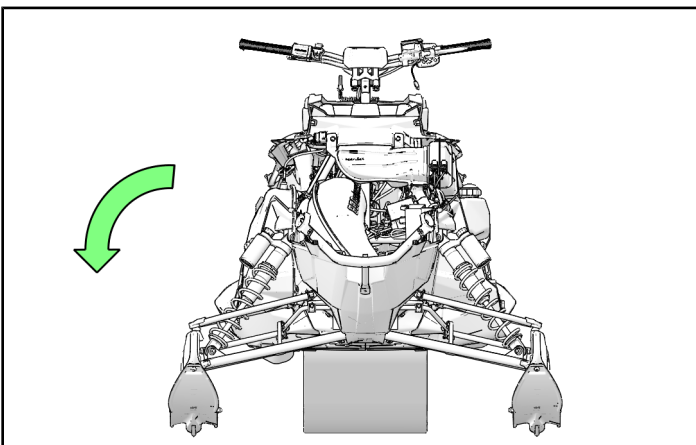

ACCESSORY INSTALLATION

- Position the Sentry Skid Plate under the front bumper mounting tab as shown. Insert the original center bumper mounting bolt and loosely install the nut you previously removed.

NOTICE

Nosepan has been partially hidden for clarity.

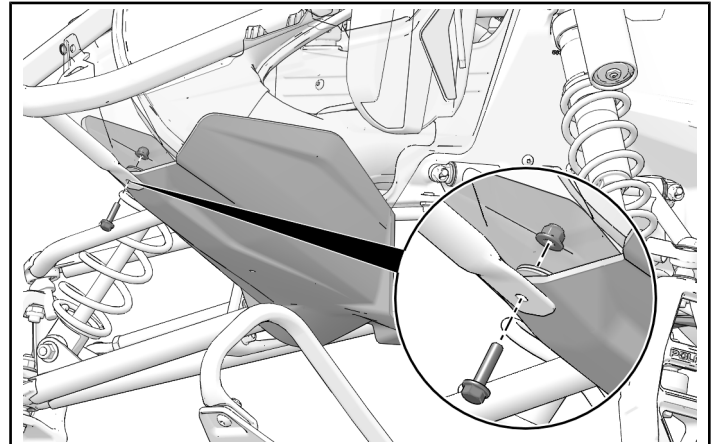

- Install the three smaller self tapping screws that came with the kit in the rear of the skid plate as shown. Tighten until snug.

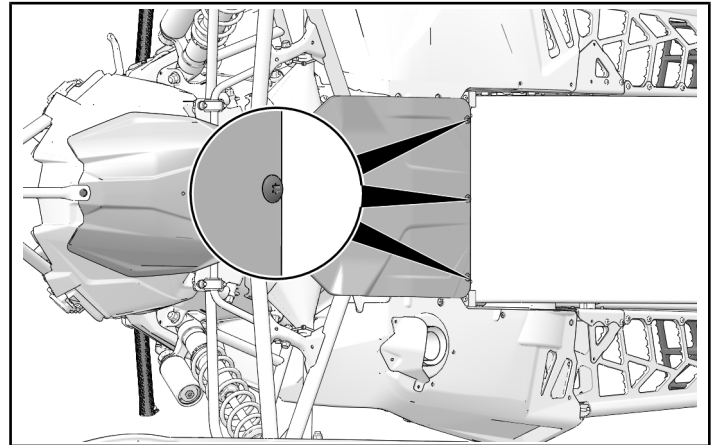

- Slowly rotate vehicle back onto the skis.

VEHICLE REASSEMBLY

GENERAL

- Reinstall all of the remaining front bumper hardware you previously loosened or removed and torque to below specification.

TORQUE

7.5 ft-lbs (10 N·m)

- Reinstall hood and side panels.
- Check to ensure all tools are accounted for and all steps have been completed.

FEEDBACK FORM

A feedback form has been created for the installer to provide any comments, questions or concerns about the installation instructions. The form is viewable on mobile devices by scanning the QR code or by clicking [HERE](#) if viewing on a PC.

