

AIRBOX UPDATE KIT PN 2871552



Application

1993-1995 Polaris SL 650, SL750 and SLT750

This kit is designed to help reduce water ingestion in conditions where the watercraft may be tipped over for an extended duration. This kit is highly recommended for rental operations and off shore riding.

NOTE: Polaris watercraft, as with any watercraft, should not be left in an un-righted position. If a watercraft is tipped over, every effort should be made to immediately return it to the full upright position. If a watercraft is left upside down or on its side, water may enter the engine and cause immediate engine damage if the starter is engaged.

NOTE: This kit should be installed by an authorized Polaris Service Technician.

Before you begin, read these instructions and check to be sure all parts and tools are accounted for.

Please retain these installation instructions for future reference and parts ordering information.

The contents of this kit include:

<u>Qty.</u>	<u>Part Description</u>	<u>Part No.</u>
3	Asm-Spacer	1253143
1	Intake Filter	2530019
1	Base, Intake	5630597
1	Cover, Intake	5432443
2	Screw, 5/16"-18 x 2.5	7517201
6	Intake Gasket	5830013
1	Fuel Pump Mounting Plate	1060120
2	Bolt, 1/4-20 x .75	7515127
2	Bolt, 1/4-20 x 1	7515174
2	Nut, 1/4-20	7542133
13	Washer, 1/4"	7555836
3	Main Jet--102.5 (750)	3130076
3	Main Jet -- 105 (650)	3140097
3	Oil Line (1994 Models Only)	8450061-31
3	Cap, Rubber	3130479
2	Cable Tie (SLTs)	7080138
1	Instructions	9913864

You will need to supply:

Phillips Screwdriver
Standard Screwdriver
Metric Socket Set
Standard Socket Set
Deep Well 10 mm" Socket
Torque Wrench
Pliers
12mm box end wrench
10mm box end wrench

IMPORTANT: Perform all items correctly and completely.

INSTALLATION INSTRUCTIONS

1. Remove the clamp which secures the air intake boot to the intake manifold base and cover, and remove air intake boot.
2. Using a Phillips screwdriver, remove the 6 screws which secure the plastic intake cover to the base. Remove the cover, screen and rubber screen gasket.
3. Remove the clamps from the oil injection lines and remove the hoses from the injector fittings.
NOTE: Do not to allow oil to drain from the hoses.
4. Remove the clamps from the fuel lines and impulse line at the fuel pump taking care not to spill any fuel.
5. Loosen and remove the 9 bolts which secure the intake manifold base to the carburetors. Take care not to let any parts or foreign material fall into the carburetors. Remove the intake manifold base.
6. Remove the fuel pump from the intake base and set aside for later use.
7. Remove the choke and throttle cables from the carburetor rack. Refer to the Master Repair Manual for the correct procedure.
8. Remove the carburetor rack. Refer to the Master Repair Manual for the correct procedure.
9. Replace the stock main jets with the jets provided in this kit. Refer to the Master Repair Manual for the correct procedure. **NOTE:** For 750 cc engines (SL750, SLT 750) use 102.5 main jets (PN 3130076). For 650 cc engine (SL650), use 105 main jets (PN 3140097).
10. Reinstall the carburetors. Refer to the Master Repair Manual for the correct procedure.
11. Re-attach the choke and throttle cables to the carburetor rack. Refer to the Master Repair Manual for the correct procedure.
12. Remove the adhesive backing from the 6 gaskets and place them onto each end of the intake spacer.
13. Place one spacer onto the top of each carburetor and place an intake base onto the top of each spacer. Be sure to place the spacer onto the carburetor as shown. The check valve fittings must point toward the rear of the watercraft.

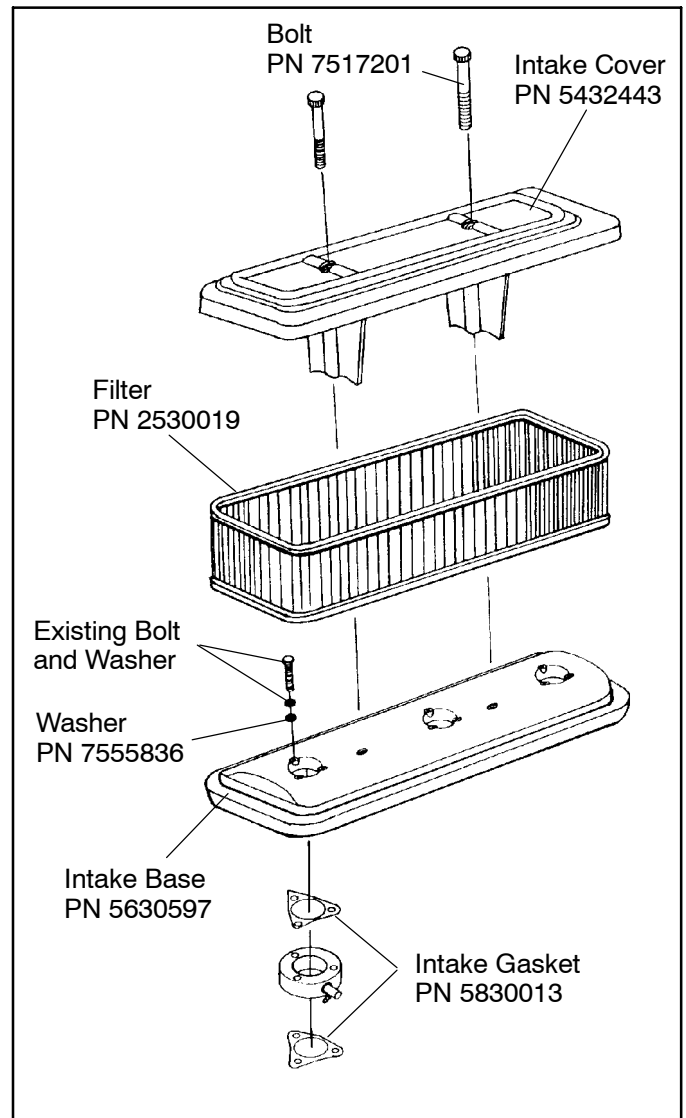

Step 13.

14. Use the existing screws to secure the intake base and spacers to the carburetors. Apply Loctite 242 to 3-5 threads of the intake base screws. Place 1/4" (PN 7555836) under each lock washer of the intake base screw. Using the deep-well 10 mm socket and a torque wrench, secure the studs with 66-78 in. lbs. (.76-.90 kg-m) of torque.
15. Place the element onto the intake base and set the cover over the element and stud. Secure with the two 5/16" screws and torque to 14 ft. lbs. (1.9 kg-m).

FOR SL MODELS ONLY

16. Using the template provided, drill two 9/32" holes into the bulkhead on the starboard side as shown.
17. Using the bolts (PN 7515127), nuts (PN 7542133), and washers (PN 7555836), attach the fuel pump plate to the bulkhead as shown and apply 8 ft. lbs (1.1 kg-m) of torque to secure.
18. Using the bolts (PN 7515174) and washers (PN7555836), attach the fuel pump to the mounting plate as shown and apply 8 ft. lbs. (1.1 kg-m) of torque to secure.

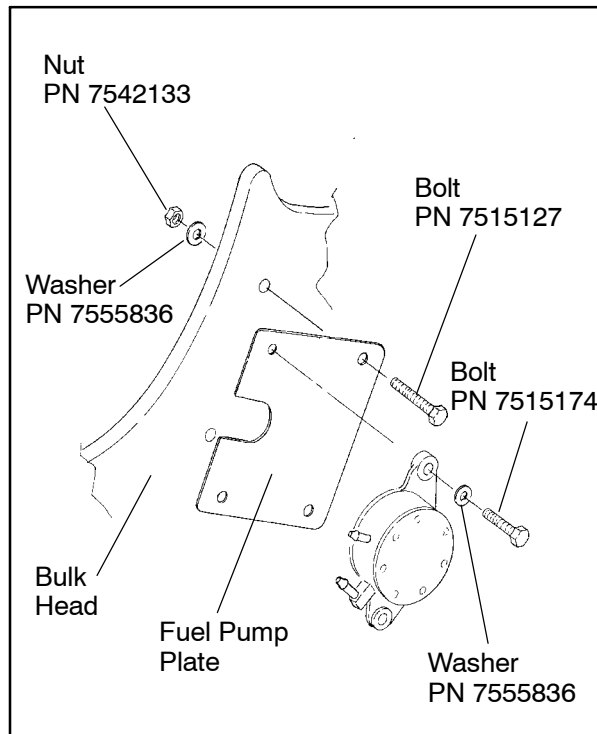

Steps 17. and 18.

FOR ALL MODELS

19. Connect the fuel line from the fuel pump to the carburetor inlet and secure with a hose clamp torqued to 10-12 in. lbs (.11-.14 kg-m).
20. Connect the oil lines from the oil pump to check valve fittings and secure with the clamps which were originally removed.

FOR 1993 AND 1994 MODELS ONLY

21. Remove the existing oil lines (pump to check valves) from the oil pump. First attach the lines included with this kit to the check valves and secure with the clamps originally removed. Fill each line with injector oil (a small squeeze bottle or oil can works well) and then attach the lines to the nipples on the oil pump. Take care to ensure that each line is full of injector oil and does not have any air bubbles. Secure with the clamps originally removed. Plug old check valves with the three rubber caps (PN 3130479).
22. On the SLT models, secure the fuel pump to the top deck using the existing fuel pump plate.

